



New Office Park In Gonzales!

Our first building is under construction and we have pad sites available.

Enjoy an office park designed to reflect a professional atmosphere with attention to details and aesthetics.

We are an Ascension Parish company and are ready to assist you with a new building pad or office building (see reverse side for details).

Please contact me, if you have any questions (225) 454-9889. I will be happy to assist you.

Tara Schroeder
Sales & Marketing
Batiment, LLC

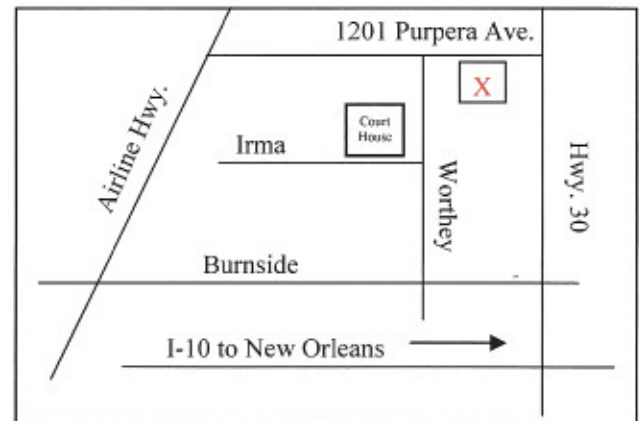

T: 225.454.9889 ♦ F: 225.673.9748 ♦ email: lloyd@dainsure.com
16179 STATE BANK DRIVE, SUITE A ♦ PRAIRIEVILLE, LA 70769



PURPERA SQUARE

Available office space and pad sites

Building 1

2396 sq. ft. (two 1198 sq. ft. units)
Available for sale or lease June 2008

Pad Site 2 – Available (3000 sq. ft.)

Pad Site 3 – Available (2000 sq. ft.)

Building 4

3,000 sq. ft. building (two 1500 sq. ft. units)
Available for sale or lease August 2008

Pad site 5 – Available (3000 sq. ft.)

Pad site 6 – Available (2480 sq. ft.)

Pad site 7 – Available (3000 sq. ft.)

Pad site 8 – Available (2000 sq. ft.)

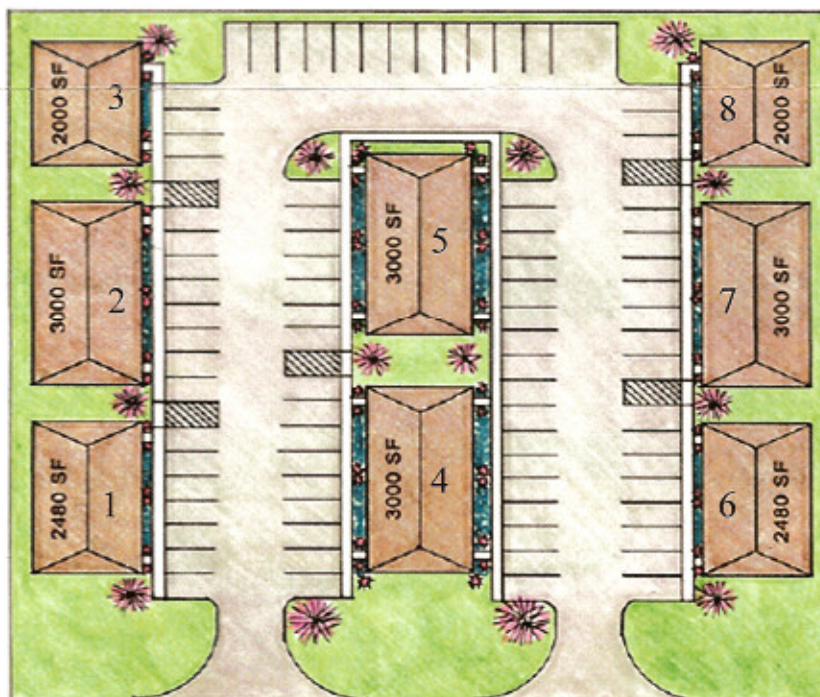

PURPERA ROAD